

POMPE  
PUMP  
BOMBA  
PUMPE

# PM 260

44403

TGV 1000-1400

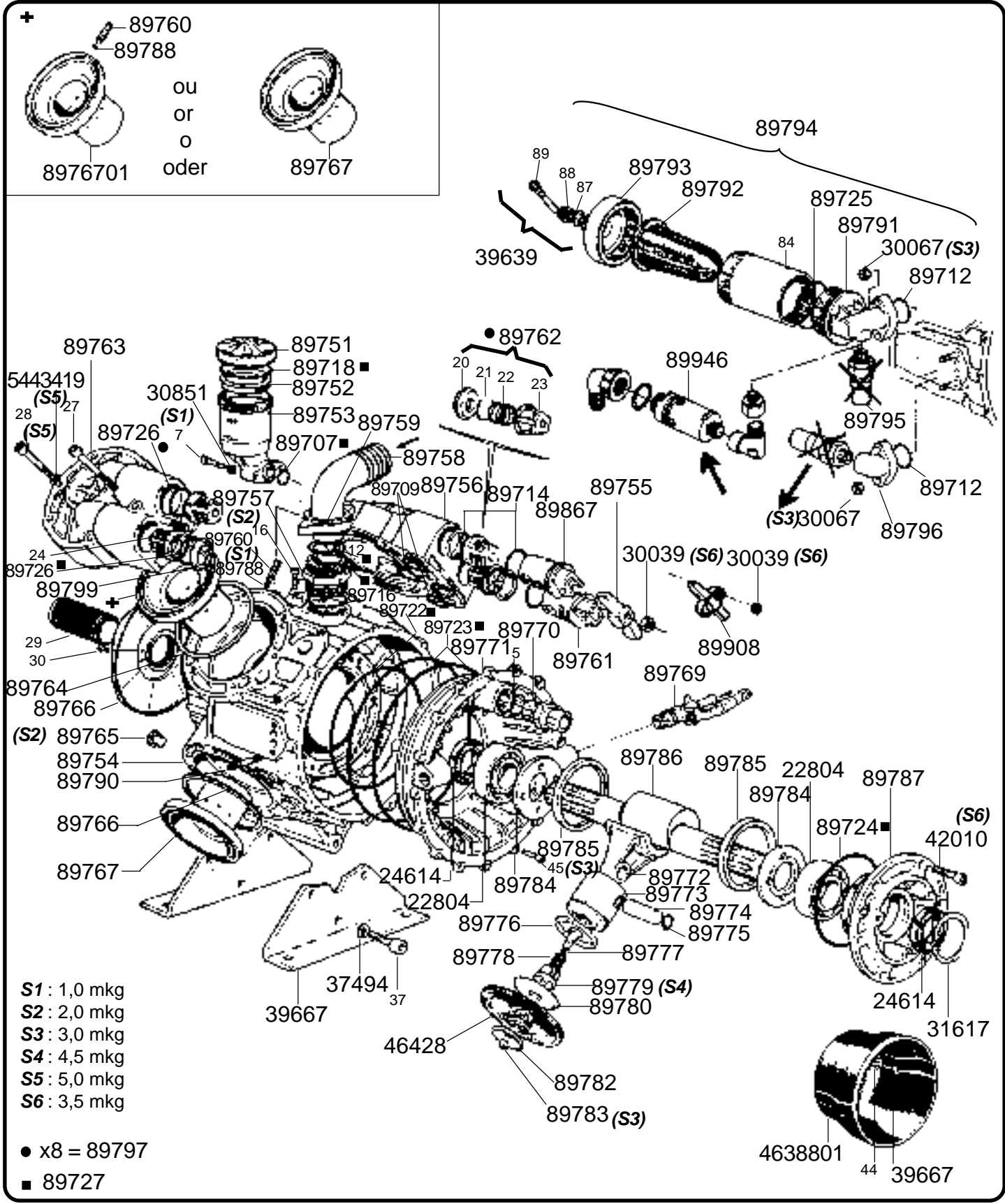

- S1 : 1,0 mkg
- S2 : 2,0 mkg
- S3 : 3,0 mkg
- S4 : 4,5 mkg
- S5 : 5,0 mkg
- S6 : 3,5 mkg

- x8 = 89797
- 89727

98726E  
06.07.2006



S.A.S Capital 1174400€ - B.P. 195 - 51206 EPERNAY - FRANCE  
Tél. 03.26.51.99.99 - Fax : 03.26.51.83.51  
R.C.S. EPERNAY B 350 484 309 - APE 293D

015.4